



Single-phase short-circuiting device for HV overhead line - CAA clamp

SR EN 61230

Code: Msp CAA - S_p / I_p - O/p (classic earthing clamp)Msp CAA - S_p / I_p - O/pr (classic earthing clamp with scraping jaw)

Intended use: earthing of conductors for HV overhead lines.

Application: from height, from the metallic brackets of HV overhead line poles.

Two application methods depending on the operator's positioning compared to the conductor:

- ✓ By hanging the clamp on the conductor followed by pulling down (if the operator is positioned under the conductor).
- ✓ By pushing and pressing the clamp on the conductor (if the operator is positioned above the conductor).

Automatic self-locking clamps (CAA) must be handled using an insulating stick according to the power line voltage.

Components:

- Self-locking automatic clamp – 1 piece
- Earthing cable – 1 piece
- Earthing clamp – 1 piece
- Mounting - dismantling adapter (AMD/E) – 1 piece / set of 3 short-circuiting devices

Packing: waterproof bag.

Operations must also include the following equipment:

- connecting insulating stick type PMU 110-2 B/ba / PMU 220-2 B/ba / PMU 400-3 B/ba

Tips: we recommend the use of manual earthing clamps with scraping jaw to clean and remove layers of oxides, dirt and protective paint from the metallic brackets of overhead line poles, in order to obtain appropriate contact resistance.

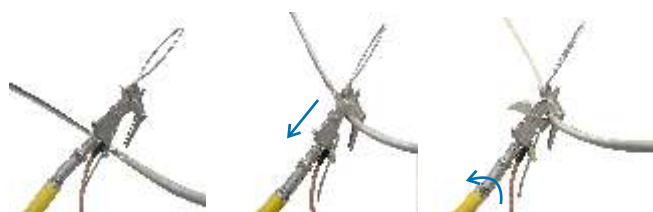
MOUNTING - DISMOUNTING
ADAPTER - AMD-E

CLAMP APPLICATION - OPERATOR UNDER CONDUCTOR

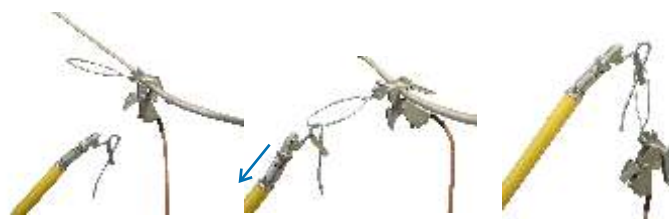

DISMOUNTING OF CLAMP

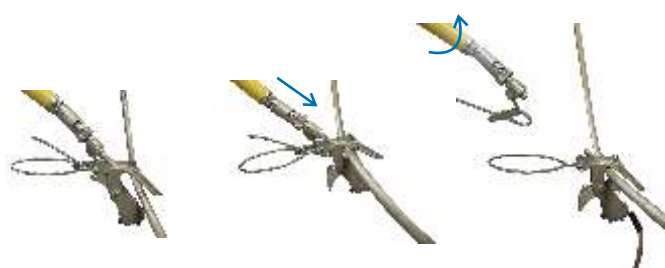

CLAMP APPLICATION - OPERATOR ABOVE THE CONDUCTOR

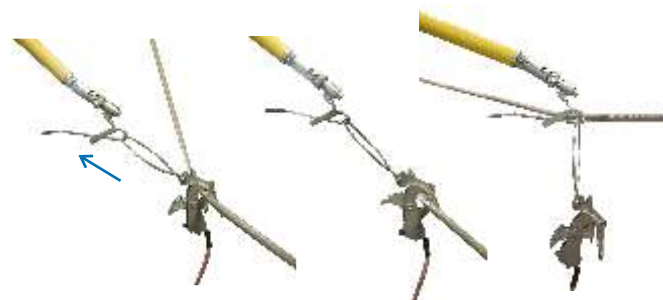

DISMOUNTING OF CLAMP

Technical characteristics

Earthing S _p cable cross-section (mm ²)	16	25	35	50	70	95
Nominal short-circuit current for t = 1 s I _{sc} (kA)	4	6,25	8	12	16	18
Shock (peak) nominal current for t = 0,02 s I _{sd} (kA)	10	15,63	20	30	40	45
Test short-circuit current for t = 1 s (kA)	4,6	7,2	9,2	13,8	18,4	20,7
Test shock (peak) current for t = 0,02 s (kA)	11,5	17,97	23	34,5	46	51,75
Power factor (according to SR EN 61230)	2,5					
Length of earthing cable I _p (m)	max. 17,5					
Diameter of the conductor where the phase clamp can be applied (mm)	5 ÷ 32			6 ÷ 32		