



## RESIN TRAP - CML-Dn type

The resin traps are designed to prevent the loss of media in the event of underdrain failure, lateral failure, strainer failure and filter nozzle failure. They are designed in various types, allowing a wide range of fluid flow rates (between 20 and 200 m<sup>3</sup>/h) and having the dimensions of the coupling flanges adapted to the assembly conditions.

At request, beside the basic types, there can be made resin traps with different dimensions adapted to the beneficiary's request.

The resin trap consist of:

- **rubberized body** provided with inlet, outlet, vent and drain flanged fittings;
- **filtering cartridge**, made of circular filtering elements from polypropylene, assembled with stainless steel ties.



### Technical characteristics

Working fluid	softened water, demineralized water
Fluid hardness	acid or alkaline (pH 2 ÷ 12)
Maximum working pressure	10 bar
Loss of pressure (bar)	0,1 ÷ 0,2 (according to the clogging level)
Working temperature	max. 80°C
Slots dimensions (mm)	0,25 ± 0,050
Fittings (according EN ISO)	flanges PU 10

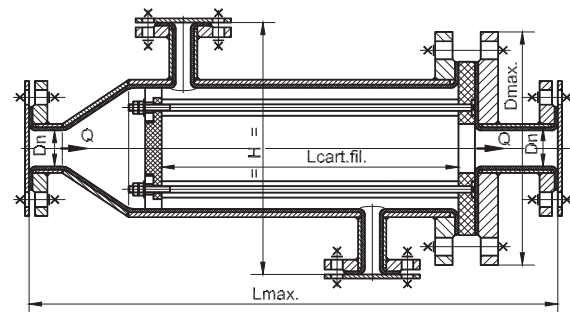

Type	Dn inlet/outlet	Q (m <sup>3</sup> /h)	Lmax (mm)	Dmax (mm)	Lcart. fil. (mm)	Number of bulged disks	H (mm)	Dn drain
CML-50	50	20	500	285	221	125	-	-
CML-80	80	40	600	285	340	195	-	-
CML-100	100	80	760	395	402	335	432	25
CML-125	125	100	830	395	476	397	432	25
CML-150	150	150	900	505	510	443	516	25
CML-200	200	200	1030	505	700	608	516	25
CML-250	250	300	1080	505	750	650	516	25